

# TRONCONNAGE FIXE : CHAINES, GUIDES BAR, PIGNONS, POUR POSTE STIHL



FIXED CHAIN SAWS : CHAIN, GUIDE BARS, GEAR, NOSE WHEEL FOR STIHL MACHINE

KAPPSTATION : KETTEN, FÜHRUNGEN, ANTRIEBSRÄDER FÜR STIHL MASCHINEN

MAQUINA FIJA PARA TRONZAR : CADENAS, ESPADAS, PIÑONES PARA MÁQUINA STIHL

TAGLIO CON CATENE : CATENE, GUIDE, PIGNONI PER MACCHINE STIHL

Type : ES121, HF121

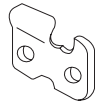
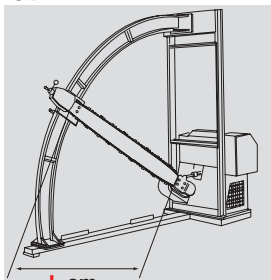

**HZ**

3 mm



**FG**

3 mm



**SK**

3 mm



**FD**

3 mm



**SKHM**

3 mm



**RS FORESTELL**

3 mm



100 cm

TRONHZ153106

TRONFG80

TRONSK153106

TRONFD80

TRONSK153106HM

TRONRS80

TRON0024

130 cm

TRONHZ153120

TRONFG91

TRONSK153120

TRONFD90

TRONSK153120HM

TRONRS90

TRON0030

160 cm

TRONHZ153140

TRONFG105

TRONSK153140

TRONFD106

TRONSK153140HM

TRONRS106

TRON0282

190 cm

TRONHZ153160

TRONFG120

TRONSK153160

TRONFD120

TRONSK153160HM

TRONRS12

TRON0032

250 cm

TRONHZ153200

TRONFG150

TRONSK153200

TRONFD150

TRONSK153150HM

TRONRS150



TRON0007

TRON0023

TRON0003

TRON0017

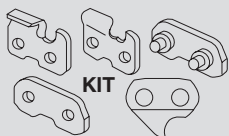

TRON0006

TRONKITFG

TRON0002

TRON0550

TRON0070



TRON1764

TRONSP

TRON1764

TRONSP

TRONSP

TRONSP



TRONSR

TRONSR

TRONSR

TRONSR

TRONSR

TRONSR

## Chaîne en rouleaux

Cutting chains in coils - Ketten in Rollen - Cadenas en rollos - Catena in rotollo

### Nombre de maillons entraîneurs par

Number of driveline per - Treibgliederanzahl pro - Número de eslabones - Numero di trascinate

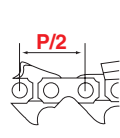

15  
19,5  
3/4  
20  
25

1014  
800  
768  
743  
600

